



Medium Voltage

# British Standard

Cable accessories for screened cables according to  
British Standard

**We connect your energy**

[www.cellpack.com](http://www.cellpack.com)



## CHM(BS)

### Single-core straight-through joint

for all polymeric single-core cables

Type CHM (BS) straight-through joints are suitable for all single-core plastic-insulated cables (PVC, PE, XLPE, EPR). They allow the connection of cables with different cross sections, conductive materials, semi-conducting layers (graphite-coated, removable or strippable) and screening (copper wire or tape).

#### Characteristics

- Reliable stress control due to flexible silicone stress control elements
- Wide cross-section area
- Quick, safe and easy assembly
- Ready for immediate operation

#### Application/Suitability

- Indoor
- Outdoor
- Underground
- Water
- Installation ducts
- Ductwork

#### Note

- Compression connectors not included

#### Storage conditions/shelf life

- Unlimited shelf life



#### Dimensions



L = Length

#### Scope of delivery

Thick wall heat-shrinkable insulation tubing, thick wall heat-shrinkable outer tubing with hot melt adhesive, stress control filling tape (blue), filling tape, silicone stress-control elements, copper braid tube, pressure springs, steel cage, assembly accessories, assembly instructions

Type	L mm	min. Ø over conductor insulation after removal of outer semi-conducting layer mm	max. Ø of connector mm	max. connector length mm	Nominal cross section mm <sup>2</sup>		Art.-No.
					12 kV	36 kV	
<b>U<sub>0</sub>/U (U<sub>m</sub>) 6/10 (12) kV - 6.35/11 (12) kV</b>							
<b>CHM(BS) 12kV</b>	400-630	1100	27.3	60	360	400-630	253845
<b>U<sub>0</sub>/U (U<sub>m</sub>) 18/30 (36) kV - 19/33 (36) kV</b>							
<b>CHM(BS) 36kV</b>	150-400	900	27.2	38	200	150-400	253844
	500-800	1100	36.8	60	360	500-800	253843

Appropriate compression connectors must be ordered separately.



## CHM3(BS)

### Three-core straight-through joint

for all 3-core polymeric cables

Type CHM3(BS) straight-through joints are suitable for all three-core plastic-insulated cables (PVC, PE, XLPE, EPR). They allow the connection of cables with different cross sections, conductive materials, semi-conducting layers (graphite-coated, removable or strippable) and screening (copper wire or tape).

#### Characteristics

- Reliable stress control due to flexible silicone stress control elements
- For all cables with copper wire or tape screen
- Wide cross-section area
- Quick, safe and easy assembly
- Ready for immediate operation

#### Application

- Indoor
- Outdoor
- Underground
- Water
- Cable ducts
- Ductwork

#### Note

- Compression connectors not included
- Joints with a range of  $U_m = 12$  kV must be used for cables of  $U_m = 7.2$  kV. (Check minimum diameter over conductor insulation)

#### Storage conditions/Shelf life

- Unlimited shelf life



#### Dimensions



L = Length

#### Scope of delivery

Thick wall heat-shrinkable insulation tubing, thick wall heat-shrinkable outer tubing with hot melt adhesive, silicone stress-control element, copper braid tube, pressure springs, stress control filling tape (blue), steel cage, assembly accessories, assembly instructions

Type	L mm	min. Ø over conductor insulation after removal of outer semi-conducting layer mm	max. Ø of connector mm	max. connector length mm	Nominal cross section mm <sup>2</sup>				Art.-No	
					12 kV	17.5 kV	24 kV	36 kV		
<b><math>U_0/U (U_m)</math> 6/10 (12)kV - 6.35/11 (12)kV</b>										
CHM3(BS) 12kV	35-95	1500	12.6	19	90	35 - 95				248770
	95-240	1500	17.3	29	125	95 - 240				248718
	150-300	1500	19.9	32	125	150 - 300				248717
<b><math>U_0/U (U_m)</math> 8.7/15 (17.5)kV</b>										
CHM3(BS) 17kV	35-95	1500	12.6	19	90		35 - 95			249471
	70-240	1500	17.3	29	125		70 - 240			249474
	120-300	1500	19.9	32	125		120 - 300			249476
<b><math>U_0/U (U_m)</math> 12/20 (24)kV - 12.7/22 (24)kV</b>										
CHM3(BS) 24kV	35-95	1500	17.3	19	90			35 - 95		253917
	70-240	1500	19.9	29	125			70 - 240		253911
	150-300	1500	23.1	32	125			150 - 300		253929
<b><math>U_0/U (U_m)</math> 18/30 (36)kV - 19/33 (36)kV</b>										
CHM3(BS) 36kV	50-150	1500	23.1	23	105				50 - 150	248716
	150-300	1500	27.3	32	125				150 - 300	248719

Appropriate compression connectors must be ordered separately.



## CHE-I(BS) Single-core indoor termination

for all polymeric single-core cables

Type CHE-I(BS) terminations are suitable for all single-core plastic-insulated cables (PVC, PE, XLPE, EPR) with different types of semi-conducting layers (graphite-coated or strippable) and screening (copper wire or tape).

### Characteristics

- Flexible silicone stress control elements ensure reliable stress control under all operating conditions
- Combination of slip-on and heat-shrink components
- Compatible with all cable lugs
- Wide cross-section range
- Quick, safe and easy assembly
- Ready for immediate operation

### Application/Suitability

- Indoor

### Note

- Cable lugs not included
- 12 kV terminations must be used for 7.2 kV cables (Check minimum diameter over conductor insulation)

### Storage conditions/shelf life

- Unlimited shelf life



### Dimensions

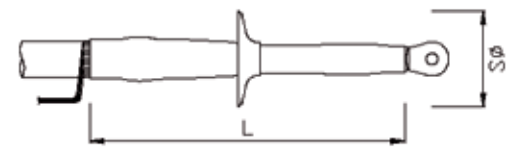

L = Length

Ø S = Diameter of shed

### Scope of delivery

1 Set for 3 phases, tracking-resistant heat-shrink tubing, silicone stress-control elements, silicone sheds, earthing kit, sealing tape, assembly instructions

Type	L mm	min. Ø over conductor insulation after removal of outer semiconducting layer mm	Number of sheds per phase	Ø S mm	Nominal cross section mm <sup>2</sup>		Art.-No
					12 kV	36 kV	
<b>U<sub>0</sub>/U (U<sub>m</sub>) 6/10 (12)kV - 6.35/11 (12)kV</b>							
<b>CHE-I(BS) 12kV</b>	400-630	400	27.3		400 - 630		253847
<b>U<sub>0</sub>/U (U<sub>m</sub>) 18/30 (36)kV - 19/33 (36)kV</b>							
<b>CHE-I(BS) 36kV</b>	150-400	600	27.3	2	115	150 - 400	253849

Appropriate compression connectors must be ordered separately.

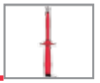

## CHE-F(BS)

### Single-core outdoor termination

for all polymeric single-core cables

Type CHE-F(BS) terminations are suitable for all single-core plastic-insulated cables (PVC, PE, XLPE, EPR) with different types of semi-conducting layers (graphite-coated or strippable) and screening (copper wire or tape).

#### Characteristics

- Flexible silicone stress control elements ensure reliable stress control under all operating conditions
- Combination of slip-on and heat-shrink components
- Wide cross-section range
- Quick, safe and easy assembly
- Ready for immediate operation

#### Application

- Outdoor

#### Note

- Cable lugs not included
- 12 kV terminations must be used for 7.2 kV cables (Check minimum diameter over conductor insulation)

#### Storage conditions/Shelf life

- Unlimited shelf life



#### Dimensions

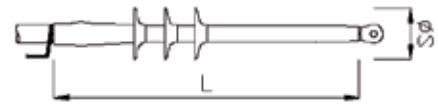

L = Length

Ø S = Diameter of shed

#### Scope of delivery

1 Set for 3 phases, tracking-resistant heat-shrink tubing, silicone stress-control elements, silicone sheds, earthing kit, sealing tape, assembly instructions

Type	L mm	min. Ø over conductor insulation after removal of outer semi-conducting layer mm	Number of sheds per phase	Ø S mm	Nominal cross section mm <sup>2</sup>		Art.-No.
					12 kV	36 kV	
U <sub>0</sub> /U (U <sub>m</sub> ) 6/10 (12)kV - 6.35/11 (12)kV							
CHE-F(BS) 12kV	400-630	400	1	115	400 - 630		253848
U <sub>0</sub> /U (U <sub>m</sub> ) 18/30 (36)kV - 19/33 (36)kV							
CHE-F(BS) 36kV	150-400	800	4	115		150 - 400	253850

Appropriate compression connectors must be ordered separately.



## CHE-3I(BS)

### Three-core indoor termination

for all 3-core polymeric cables

Type CHE-3I(BS) terminations are suitable for all three-core plastic-insulated cables (PVC, PE, XLPE, EPR) with different types of semi-conducting layers (graphite-coated or strippable) and screening (copper wire or tape).

#### Characteristics

- Flexible silicone stress control elements ensure reliable stress control under all operating conditions
- Combination of slip-on and heat-shrink components
- Compatible with all cable lugs
- Wide cross-section range
- Quick, safe and easy assembly
- Ready for immediate operation

#### Application/Suitability

- Indoor

#### Note

- Cable lugs not included
- 12 kV terminations must be used for 7.2 kV cables (Check minimum diameter over conductor insulation)

#### Storage conditions/shelf life

- Unlimited shelf life



#### Dimensions

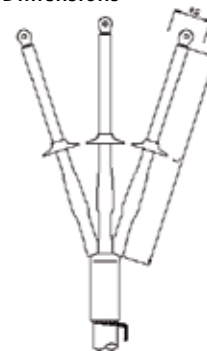

L = Length  
Ø S = Diameter of shed

#### Scope of delivery

Tracking-resistant heat-shrink tubing, tracking resistance Spreader cap, silicone stress-control elements, silicone sheds, earthing kit, sealing tape, assembly instructions

Type	L mm	min. Ø over conductor insulation after removal of outer semi-conducting layer mm	Number of sheds per phase	Ø S mm	Nominal cross section mm <sup>2</sup>			Art.-No.
					12 kV	17.5 kV	36 kV	
U <sub>0</sub> /U (U <sub>m</sub> ) 6/10 (12)kV - 6.35/11 (12)kV								
CHE-3I(BS) 12kV	25-95	350	12.6		25 - 95			249328
	95-240	350	17.3		95 - 240			249331
	150-400	350	19.9		150 - 400			249332
U <sub>0</sub> /U (U <sub>m</sub> ) 8.7/15 (17.5)kV								
CHE-3I(BS) 17kV	25-50	400	12.6			25 - 50		249468
	150-300	400	19.9			150 - 300		249469
U <sub>0</sub> /U (U <sub>m</sub> ) 18/30 (36)kV - 19/33 (36)kV								
CHE-3I(BS) 36kV	50-150	650	23.1	2	85		50 - 150	249333
	150-400	650	27.3	2	115		150 - 400	249334

Appropriate compression connectors must be ordered separately.



## CHE-3F(BS)

### Three-core outdoor termination

for all 3-core polymeric cables

Type CHE-3F(BS) terminations are suitable for all three-core plastic-insulated cables (PVC, PE, XLPE, EPR) with different types of semi-conducting layers (graphite-coated or strippable) and screening (copper wire or tape).

#### Characteristics

- Flexible silicone stress control elements ensure reliable stress control under all operating conditions
- Combination of slip-on and heat-shrink components
- Compatible with all cable lugs
- Wide cross-section range
- Quick, safe and easy assembly
- Ready for immediate operation

#### Application/Suitability

- Outdoor

#### Note

- Cable lugs not included
- 12 kV terminations must be used for 7.2 kV cables (Check minimum diameter over conductor insulation)

#### Storage conditions/shelf life

- Unlimited shelf life



#### Dimensions

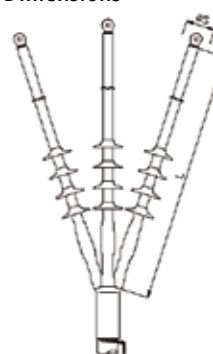

L = Length  
Ø S = Diameter of shed

#### Scope of delivery

Tracking-resistant heat-shrink tubing, tracking resistance Spreader cap, silicone stress-control elements, silicone sheds, earthing kit, sealing tape, assembly instructions

Type	L mm	min. Ø over conductor insulation after removal of outer semi-conducting layer mm	Number of sheds per phase	Ø S mm	Nominal cross section mm <sup>2</sup>			Art.-No.
					12 kV	17.5 kV	36 kV	
U <sub>0</sub> /U (U <sub>m</sub> ) 6/10 (12)kV - 6.35/11 (12)kV								
CHE-3F(BS) 12kV	25-95	1200	12.6	1	85	25 - 95		249191
	95-240	1200	17.3	1	85	95 - 240		249192
	150-400	1200	19.9	1	85	150 - 400		249193
U <sub>0</sub> /U (U <sub>m</sub> ) 8.7/15 (17.5)kV								
CHE-3F(BS) 17kV	25-50	1200	12.6	2	85		25 - 50	249464
	150-300	1200	19.9	2	85		150 - 300	249466
U <sub>0</sub> /U (U <sub>m</sub> ) 18/30 (36)kV - 19/33 (36)kV								
CHE-3F(BS) 36kV	50-150	1200	23.1	3	85			50 - 150 249194
	150-400	1200	27.3	3	115			150 - 400 249195

Appropriate compression connectors must be ordered separately.

**AUF(BS)****Armour continuity kit for three-core joints**

for all 3-core polymeric cables

Armour continuity for armoured three-core polymeric cables in accordance with British Standard.

**Characteristics**

- Superior electrical properties
- High mechanical strength
- Quick, safe and easy assembly

**Application/Suitability**

- Earthing continuity and earth contactor
- For cast resin, heat-shrink and slip-on cable accessories
- Enables solder-free electrical connection of metal cable components (screen, armouring, metal sheath)

**Storage conditions/shelf life**

- Unlimited shelf life

**Dimensions**

L = Length

**Scope of delivery**

Hose clamp, steel cage, backup-ring, cloth tape

Type	L mm	Internal-Ø mm	Cross section mm <sup>2</sup>					Art.-No.	
			7.2 kV	12 kV	17.5 kV	24 kV	36 kV		
AUF	1100/53	1100	53	150	95	70	50		195369
	1100/73	1100	73	150 - 300	120 - 300	95 - 240	70 - 150	95	195380
	1100/87	1100	87			150 - 300	150 - 300	120 - 185	195381
	1100/97	1100	97					150 - 300	195382



## EGA(BS) Earthing accessories

for cables with tape screen and/or armouring for terminations

Type EGA(BS) earthing kit for three-core polymeric cables in accordance with British Standard.

### Characteristics

- Superior electrical properties
- High mechanical strength
- Suitable for indoor and outdoor use
- Quick, safe and easy assembly

### Application/Suitability

- Earth connection and contactor
- For cast resin, heat-shrink and slip-on cable accessories
- Enables solder-free electrical connection of metal cable components (screen, armouring, metal sheath)

### Storage conditions/shelf life

- Unlimited shelf life



### Dimensions



L = Length

### Scope of delivery

Earthing wire, earthing accessories, pressure springs, backup-ring, cable lug, hose clamp, heat-shrink tube

Type	Nominal cross section Copper braid mm <sup>2</sup>	Cross section mm <sup>2</sup>					Internal-Ø mm	Art.-No.
		7.2 kV	12 kV	17.5 kV	24 kV	36 kV		
EGA3BS(53)	25	150	95	70	50		53	185050
EGA3BS(68)	25	150 - 240	120 - 240	95 - 185	70 - 150	50	68	185051
EGA3BS(73)	25	240 - 300	185 - 300	150 - 240	120 - 185	70 - 95	73	185052
EGA3BS(87)	35			185 - 300	185 - 300	120 - 185	87	185053
EGA3BS(97)	35					185 - 300	97	185054

**CG****Cable entry points for XLPE - and paper-insulated cables**

for all 3-core polymeric cables

Cable entry point for junction boxes for transformers and substations.

**Scope of delivery**

Heat-shrink tube, 1 Cable entry point, assembly accessories, assembly instructions

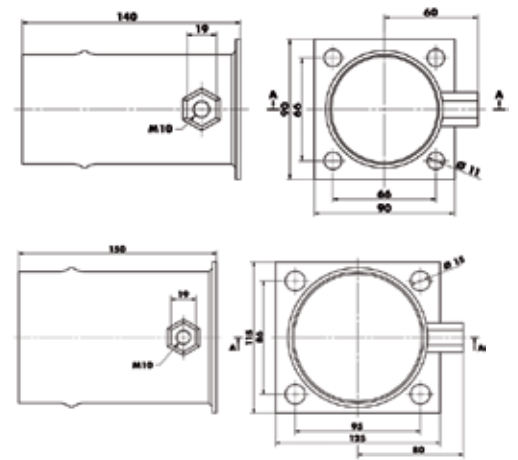
**Dimensions**CG A  
CG B

Type	Ø mm <sup>2</sup>		Art.-No.
	under armoring paper-insulated cable	under armoring XLPE-cable	
CGA	30 - 46	36 - 52	183662
CGB	47 - 75	53 - 80	183661



## INTERNATIONAL SALES ORGANISATIONS

### Europe

**Cellpack AG**  
**Electrical Products**  
Anglikerstrasse 99  
5612 Villmergen  
Schweiz  
Phone +41 56 6181 234  
Fax +41 56 6181 245  
verkauf.epschweiz@cellpack.com

**Cellpack Benelux B.V.**  
Keersluisweg 13  
1332 EE Almere Buiten  
Nederland  
Phone +31 36 549 03 36  
Fax +31 36 532 74 99  
info@cellpack.nl

**Cellpack Polska Sp. z o.o.**  
ul. Matuszewska 14,  
03-876 Warszawa  
Polska  
Phone +48 22 853 53 54  
Fax +48 22 853 53 56  
biuro@cellpack.pl

**Behr Bircher Cellpack BBC Italia S.r.l.**  
Via Petrarca, 2  
22100 Como  
Italia  
Phone +39 349 903 41 61  
epitalia@cellpack.com

**Behr Bircher Cellpack**  
**Ibérica, S.A.**  
C/.Mas Pujol, nr. 47 – Nave 4  
Pol. Ind. Sector V  
08520 – Les Franqueses del Vallès  
Barcelona – España  
Phone +34 93 846 63 76  
Fax +34 93 849 12 06  
comercial@cellpackiberica.com

**Behr Bircher Cellpack**  
**BBC France s.à.r.l.**  
277, Boulevard des Technologies  
54710 Ludres  
France  
Phone +33.3.83.25.60.07  
Fax +33.3.83.25.88.27  
info@cellpack-ep.fr

### International Distributors

**Cellpack AG**  
**Electrical Products**  
Anglikerstrasse 99  
5612 Villmergen  
Schweiz  
Phone +41 56 6181 818  
Fax +41 56 6181 245  
EPSalesExport@cellpack.com

### Middle East

**Behr Bircher Cellpack**  
**Middle East FZ-LLC**  
B12-210  
Academic Zone 01-Business Center 5  
RAKEZ Business Zone-FZ  
R.A.K / United Arab Emirates  
Phone +971 50 952 2800  
EPSalesME@cellpack.com

### Asia Pacific

**Bircher Cable Connection**  
**& Grid Systems Pvt. Ltd.**  
801, 8th Floor, NDM-1, Blocks-B,  
Netaji Subhash Place,  
Pitampura, New Delhi-110034  
India  
Phone +91 11 40 89 49 607  
info.india@cellpack.com

**Behr Bircher Cellpack BBC Far East**  
**Pte Ltd**  
128 Joo Seng Road # 06 – 01  
Singapore 368356  
Phone +65 6747 7024  
Fax +65 6841 4554  
info@cellpack.com.sg

**Behr Bircher Cellpack**  
**BBC Malaysia Sdn. Bhd.**  
No 17, Jalan Laman Setia 7/3  
Setia Business Park  
81550 Gelang Patah  
Johor  
Malaysia  
Phone +60 7 559 0570  
Fax +60 7 559 0571  
info@cellpack.com.my  
www.cellpack.com.my

**Behr Bircher Cellpack**  
**BBC Australia Pty Ltd**  
PO Box 73  
Oakdale, NSW, 2570  
Australia  
Phone +61 407 103 621  
Fax +61 2 4659 6531  
New Zealand  
Phone +64 21 591 960  
Fax +64 9 436 0897  
salesanz@cellpack.com

