

# Screw-branch-off-connector Type AK



◆ Space saving ◆ Simple installation ◆ Electrically safe

Systems For Professionals

**CELLPACK**  
Electrical Products

## Screw-branch-off-connector Type AK

The screw-branch-off-connector Type AK is suitable for branching-off and jointing conductors in aluminium or copper. This innovative connector guarantees safe connections with the following properties:

- The connector is in parts, therefore it is not necessary to cut the main conductor, but only remove the insulation.
- A grey polycarbonate insulation shields the screw and metal body, avoiding any risk of contact between phases.
- The compact construction allows connections within small spaces.
- The specially tin-plated brass contacts guarantee an optimised connection.
- The insulation of the connector, from the AK 50 upwards, is designed so that they can be easily clipped together.



### Y-branch-joints with cast resin including 5 AK-screw connectors

Article	L mm	T mm	H mm	W mm	max. Ø mm main cable	Nominal cross section per wire mm <sup>2</sup> main cable / stub cable	Article-No.
Y 0-V-AK	185	45	55	80	8 - 17	1,5 - 6	299001
Y 1-V-AK	240	60	70	110	9 - 22	2,5 - 10	299002
Y 2-V-AK	285	65	75	120	23 - 37	6 - 25	299003

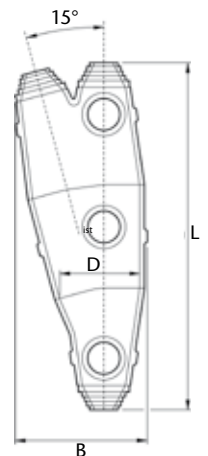

### AK-Connectors as individual items

Article	L1 mm	L2 mm	W mm	H mm	Unit	Max. cross section mm <sup>2</sup> main cable / stub cable	Article-No.
AK 6	11.5		9.0	19	100	6 / 6	131050
AK 10	12.5		10.5	22	100	10 / 10	131049
AK 16	14.0		12.0	26	100	16 / 16	131048
AK 25	17.5		14.0	29	50	25 / 25	131047
AK 35	21.0		17.5	41	50	35 / 35	131045
AK 50	23.0	50	19.0	46	50	50 / 50	258494
AK 70	28.0	57	24.0	50	50	70 / 70	258495
AK 150	37.0	64	33.0	65	15	150 / 150	258496

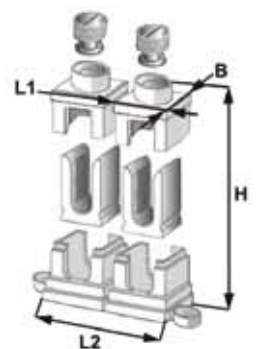

Further informations concerning our products:

Cellpack GmbH | Carl-Zeiss-Strasse 20 | 79761 Waldshut-Tiengen  
 Tel.: +49 7741 6007-0 | Fax: +49 7741 64989 | electrical-products@cellpack.com

