



Low voltage

Universal Box CG

Reliable protection of WAGO COMPACT splicing connectors using OBO BETTERMANN cable junction box and label free BBC Cellpack cast resin, no hazard label required

We connect your energy

www.cellpack.com

0921

Permanently sealed and installed in just a few minutes

The Universal Box CG from BBC Cellpack allows you to easily and reliably protect your electrical connections, even in harsh ambient conditions, in just a few simple steps.

The new generation of Universal Box CG combines the advantages and wide range of applications of OBO BETTERMANN's high-quality cable junction boxes with the outstanding protective properties of the professional BBC Cellpack cast resin. The cast resin does not require any hazard labels. The various housing sizes of the junction boxes are combined with the WAGO COMPACT 221 series splicing connectors provided by the market leader. Seven membrane entries provide you with maximum flexibility when determining the direction of the cable feeds and the number of connections. The user-friendly complete set also includes the translucent, removable BBC Cellpack 2-component hydrocarbon resin CG. This cast resin does not require any hazard labels. This makes it possible to carry out a visual inspection and subsequent installations at any time. The soft-elastic character of the sealing compound provides long-lasting protection for electrical connections indoors and outdoors against water penetration and vibrations. It also prevents condensation buildup.



PRACTICAL



ACCESSIBLE



VARIABLE

Product advantages

- High-quality branch boxes from OBO BETTERMANN available in various housing sizes
- Fitted with WAGO COMPACT 221 series splicing connectors
- Durable protection against moisture and is waterproof
- Universally suitable as connection and cable junction box
- High flexibility and visual control thanks to removable translucent CG cast resin
- Simple, vertical casting via a funnel

Applications and properties

- Voltage level 230/450 V
- Outdoor applications
- Indoor areas with high exposure to moisture
- Earth
- Protection class: IP68 with cast resin tested according to DIN EN 60529
- Halogen-free
- UV-resistant cable junction box
- CMR, isocyanate and silicone-free cast resin, no hazard label required
- Translucent, even after hardening
- Environmentally compatible
- Functionally reliable even when exposed to permanent moisture

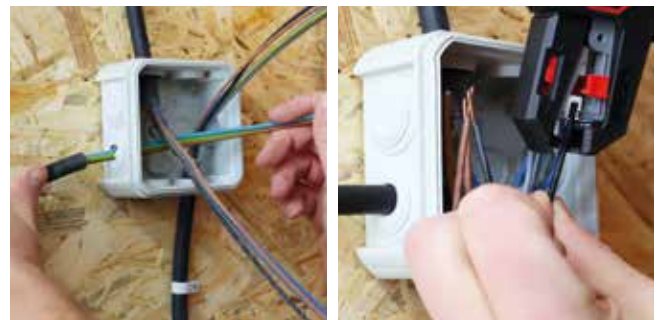

The new generation Universal Box CG makes it easy to quickly connect cables in a user-friendly manner in only a few steps. Seven membrane entries, which are positioned on the side of the box, provide flexible cable entries. The supplied WAGO COMPACT splicing connectors make wiring in the various housing sizes extremely convenient.

The translucent and removable CG cast resin enables visual inspections at any time. After removing the sealing compound, the connection point can be accessed again and allows subsequent modifications.



The Universal Box CG is the ideal solution wherever a permanently reliable junction box is required under harsh ambient conditions, e.g. for door drives, in washing systems, gardens, cellars and spa areas, etc.





Scope of delivery

2-component hydrocarbon resin CG, measured out in a practical two-chamber mixing bag so that it is ready to mix, high-quality cable junction box from OBO BETTERMANN, WAGO COMPACT 221 series splicing connectors, funnel for convenient vertical casting, emery cloth and installation instructions.

Product and order information

WAGO COMPACT 221 series splicing connectors

Type	OBO BETTERMANN cable junction box	WAGO COMPACT splicing connectors	Nominal cross-section per core mm ²	Cast resin does not require a hazard label ml	Art. no.
Universalbox CG	T40	 5 x 221-413	0,14f / 0,2 - 4	275	425589
	T60	 5 x 221-613	0,5 - 6	420	428123
	T100	 5 x 221-615	0,5 - 6	730	428124

OBO BETTERMANN cable junction box

Technical data	OBO BETTERMANN cable junction box type		
	T40	T60	T100
Dimension (LxBxH) mm, inside	77x77x46	100x100x48	136x102x57
outside	90x90x52	114x114x57	150x116x67
Entry point	7 x M20	7 x M20	10 x M20
Cover catch	Snap closure	Screw cap	Screw cap

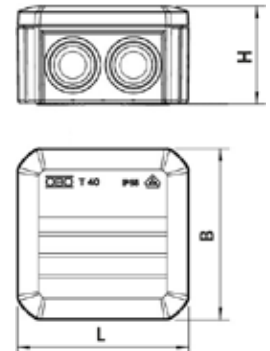

BBC Cellpack 2-component label free hydrocarbon CG cast resin for refilling

Type	Content ml	Art. no.
Cast resin CG	143	362398
	250	362399
	275	434565
	420	434566
	730	362410
	1000	363564
	2000	362411

BBC Cellpack GmbH
BBC Cellpack Electrical Products
 Carl-Zeiss-Straße 20 | 79761 Waldshut-Tiengen | Germany
 Tel. +49 7741 6007-0 | Fax: +49 7741 64989
 electrical.products@cellpack.com



More information about
 our products:
electricalproducts.cellpack.com

www.cellpack.com